

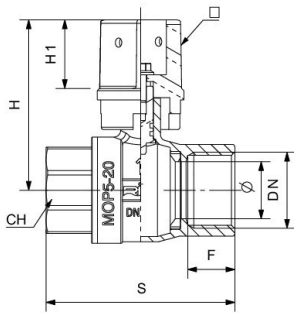

RIV 4195

Ball valve F/F
 full bore
 brass square cap

Tech drawings and tables



DN	Code	Ø	H	S	F	H1	PN	KG	P/box
1/2"	024195000004	15	63	59	17	30	28 64	0,337	10
3/4"	024195000005	20	70	69	18	30	28 40	0,479	10
1"	024195000007	25	74	83	22	30	28 40	0,680	10
1"1/4	024195000008	32	86	94	24	30	28 40	0,958	6
1"1/2	024195000009	40	95	102	24	30	28 40	1,231	4
2"	024195000011	50	102	124	28	30	28 40	1,844	4
2"1/2	024195000013	65	121	148	30	30	28 40	3,973	1
3"	024195000014	80	131	171	33	30	28 32	5,317	1
4"	024195000016	100	166	206	40	30	29 25	8,580	1

Technical data

Art. 4190

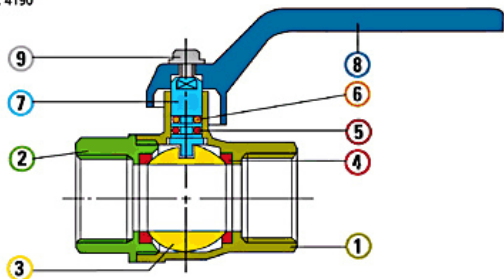

Materials

1	Body	Brass	CW617N	Nickel-plated
2	Body end	Brass	CW617N	Nickel-plated
3	Ball	Brass	CW617N	Chrome-plated
4	Seats	P.T.F.E.		
5	O-Ring	FKM		
6	O-Ring	NBR		
7	Stem	Brass	CW614N	
8	Lever	Aluminium		Green
9	Screw	Steel		Zinc-plated

Connections F/F: ISO 7/1Rp (parallel), ISO 7/1Rc (tapered), ANSI B1.20.1 (NPT) - M/F: male ISO 7/1R (tapered), female ISO 7/1Rp (parallel) - M/M: ISO 7/1R (tapered)

Limit -20°C (without liquid) +150°C

Notes The max.working pressure (PN) means at a room temperature of about 23°C.

Pressure Loss Chart

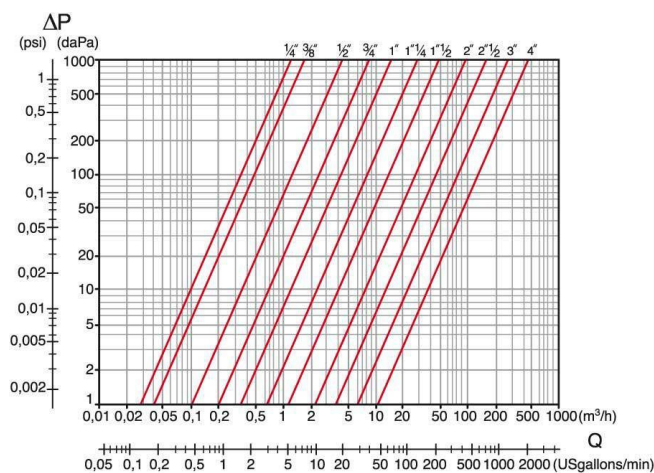

Temperature/Pressure

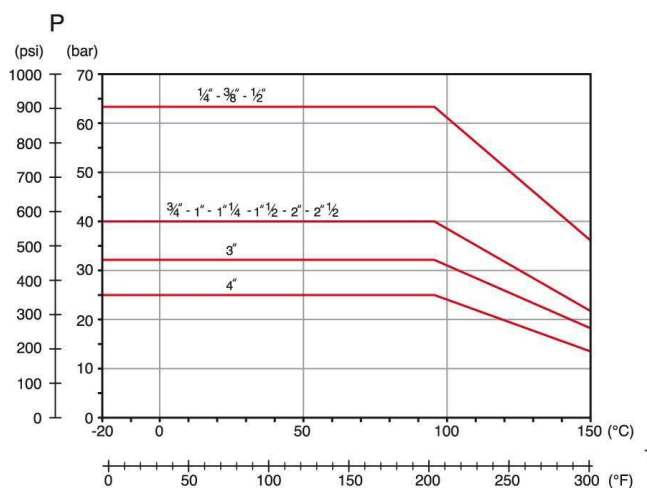

Kv & Cv Coefficients

Size	Kv	Cv
1/4"	4,1	4,7
3/8"	6,3	7,3
1/2"	15,5	17,9
3/4"	31,0	36,0
1"	52,0	60,0
1"1/4	100,0	116,0
1"1/2	180,0	206,0
2"	350,0	405,0
2"1/2	350,0	671,0
3"	1000,0	1157,0
4"	1550,0	1793,0